

May 2022 | NO.418

今日家居[®]

INNOVATION IN LIFE - STYLE

TODAY'S LIVING

Inspirational
interiors from
1,100 - 3,552 sq.ft.

Cover Story

尚珩 2,200 呎

La Cresta

Designed by

Edward Lau



室內設計

Special Supplement

客廳傢具新品

Living Large

Living Plus Hotel 度身訂製養生康體旅程

HK \$35
A Bilingual Interiors Monthly





House of Style

雙城·記

本案位於湖南長沙國際金融中心，SLD 設計團隊在主樓 72 層，以「雙城·記」為靈感，輔以奢侈品牌 Hermès 愛馬仕風格為基礎，重塑經典概念，打造中西美學風雅之境。Decorated largely in shades of beige, dark oak and white marble, this striking show flat in Hunan province embraces a rich heritage that's pays homage to the iconic Hermès brand.

Text by Joyce Kwok & Eleanor Manning
Interior design & photo courtesy of
SLD Design Group



1. 客廳坐擁十二米面寬，超然的空間感十分震撼。室內有定制馬鞍型座椅器具呼應主題，親朋好友無論商談或品茗均盡見品味。|| Drawing inspiration from the leather artisanship demonstrated by iconic fashion house, Hermès, this elegant show flat is located in the prominent Changsha IFS building.

2. 無邊水景橫貫廳堂，置雕塑以歐式拱門造型立於其中，底部雕刻城市佈局映於水面，「雙城」形象化。|| Known as the Sky Villa, the show flat has been styled in shades of beige, dark oak and white marble, which have been embellished with quality leather, buckles, saddles and stirrups.

這是一個擁有三間套房、一間書房以及超大型客飯廳的大平層戶型。設計靈感以「雙城·記」為題，靈感源於《雙城記》中「我希望你知道你是我靈魂的最終的夢想」。繪意項目是一場中國長沙與巴黎的一場跨國界文化交流。

歸家儀式感

入口採用雙動線，主人和傭人分別從不同路徑入戶。步入玄關，映入眼簾的是一幅橙色皮革牆面，靈感來自愛馬仕的包裝盒，讓戶主進入屋便有打開禮物的驚喜感，加上設有古銅金屬質感的弧形藝術漆背景牆，給玄關增添穩重的歸家儀式感。

大氣風範

客、飯廳寬達兩米，兩個空間設計融為一體，地板採用柏尼斯灰大理石，弧形天花髹上淺駝色的藝術漆，精巧細緻。客飯廳擺放 Hermès、Chi Wing Lo 及 Poltrona Frau 的傢具。地毯採用大色塊元素，靈感是來自愛馬仕的女士條紋長披肩。走到幕牆前會看到無邊際水景設

計，其上的雕塑「鏡·雙城」，靈感源自歐洲拱門的線條，由水中映照長沙城市的倒影，將巴黎與長沙以富趣味形式展現出沒有國界的藝術對話。飯廳旁以開放式設計，陳列牆設計靈感源自日本建築大師坂茂為愛馬仕設計的紙管建築，代表奢華的橘色和米色皮革結合木飾面及古銅金屬材質重新組合，構成流暢的弧形線條，如絲帶的造型詮釋出優雅和藝術味。

一絲不苟

穿過屏風旋轉門來到書房，透過可開合可開敞的旋轉門與客廳組成一體呼應的空間，不但可用作獨立書房，亦可納入為戶主的專屬區域。旋轉門採用實木、金屬、皮革的材質完成，傳統中國木工元素結合手工的車線工藝和金屬壓扣的細節，均源於愛馬仕 Kelly 皮包。書櫃設計採用北美橡木結合手工藝術漆，體現簡潔大氣的感覺，擺放愛馬仕彩繪碟、藏書、畫作等，彰顯戶主的獨特品味。





1. 長達九米的藝術展示櫃令人驚歎，展櫃融入愛馬仕絲帶與馬鞍元素，無盡優雅與藝術氣息盡收眼底。
|| A striking nine-metre-long display cabinet in the lounge pays tribute to Hermès' paper house pavilion by acclaimed Japanese architect Shigeru Ban.
2. 項目以奢侈品牌愛馬仕為靈感，運用極致細節，彰顯豪華大宅魅力。
|| Leading to the study, beautiful bespoke rotating wood screens have been carved with traditional Chinese woodworking details.
3. 客飯廳與書房相連，屏風門採用傳統中式木工元素，結合愛馬仕 Kelly 皮包經典的壓扣設計。四扇屏風門合則如空間內壁，開則風度四溢，彰顯居者威嚴。
|| The wooden screens blend seamlessly with French leather craftsmanship and striking metal buckle features, which perfectly embody the East meets West aesthetics

Data

Location: Changshu IFS Sky Villa, China
中國長沙國際金融中心 Sky Villa
Size: 3,552 sq.ft.

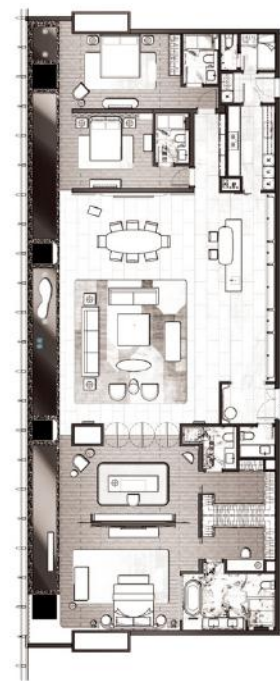

風格獨特

主人睡房盡顯豪宅優勢，弧形的米色背景牆靈感源自中國古代的枕頭元素，以編制皮革結合鑲嵌圓弧形實木條，充滿韻律感，與天花的弧形藝術漆吊頂造型遙相呼應。頂級傢俱品牌 Chi Wing Lo 的床具，搭配愛馬仕躺椅和落地燈，其弧形的傢具細節和跟整體硬裝線條一致，體現柔和感覺，使戶主可在此享受休息時間。電視櫃上方為藝術家何錕的作品《纏繞》，作品裡的動和靜對比是自我矛盾的反復融合，利用無限延展的儀式個性地重現個人獨特風格。





1. 主人房的吊頂、床凳與背景牆均見馬鞍之弧度，既是優雅之姿，亦是摺有之意，使人易於卸下壓力，與舒適擁抱共眠。|| Smooth shapes married with cream accents and hints of Hermès signature orange define a sense of refined sophistication permeating the master bedroom.

2. 背景牆以編制皮革鑲嵌圓弧實木條子設計，創造出細膩觀感。|| As a result, a timeless sense of elegance has been clearly articulated through a contemporary design approach.

3. 浴室採用電動霧化玻璃與主人房分隔，採光和隱私性俱備。圓弧鏡箱和櫥櫃抽屜把手低調地呼應空間主題。|| The ultra-luxury en suite bathroom is a triumph of lush marbles and rich wooden textures, crafting the most perfect bespoke spa experience.

4. 浴室浸淫在法國黑珍珠大理石的奢華氣質中，令戶主沉醉於沐浴的快樂時光。|| The design team were keen to reflect the exquisite flair of Hermès throughout each corner of the space, creating a design scheme that echoes the prestige of its prime location.

Drawing inspiration from the superb leather artisanship and expertise demonstrated by the iconic fashion house, Hermès, this elegant show flat is located in the prominent Changsha IFS landmark. The tallest building in the city, Changsha IFS is an integrated community hub encompassing a thriving commercial destination and a place that brings together arts, culture and events. As such, the design team were keen to reflect the exquisite flair of Hermès throughout each corner of the space, creating a design scheme that echoes the prestige of its prime location.

Known as the Sky Villa, the show flat has been styled in shades of beige, dark oak and white marble, which have been embellished with quality leather, buckles, saddles and stirrups, subtly echoing the heritage of the Hermès brand. Defined by

simple lines, the waterscape strikingly rests at the window-side of this spacious living and dining room. Its sculpture lends the outline of European Arches while the carving of Changsha cityscape gracefully mirrored on the water adds an artistic touch to the contemporary space.

Leading to the study, beautiful bespoke rotating wood screens have been carved with traditional Chinese woodwork details, and blend seamlessly with French leather craftsmanship and striking metal buckle features, which perfectly embody the East meets West aesthetics. In addition, the property has been decorated with handpicked Hermès and Chi Wing Lo furniture and decor, creating a refined sense of sophistication.





1.

1. 意大利頂級傢具品牌 Giorgetti 的床具搭配 Porro 床頭櫃和拼色木皮設計的斗櫃，前衛的傢具給居住者帶來非凡活力。|| The harmonious blend of soothing colours intertwined with carefully selected materials subtly express a sense of understated luxury in this elegant show flat.

2. 孩子房的橘紅色背景給人一種年輕時尚之感，床品也以明快大膽的純色點綴空間。|| When it came to the interior, no detail is too small for the design team, who have paired blood reds with neutral shades of taupe to create an expensive vibe in the second bedroom.

3. 長輩房中一抹倒立懸松取「四季常青」、「時光逆齡」之意。米色彰顯溫雅低調，更富長者風範。|| Meanwhile, the team have chosen a slightly lighter palette in the third bedroom, echoing the poetic silhouette of the apartment through a delicate intertwinement of materials. 📌



2.



3.